

# FOR LEASE

## PRIME RESTAURANT SPACE

90 George St., Ottawa, Ontario



- Prestigious address in the Byward Market
- Half block east of the Rideau Centre
- Second floor premises overlooking George St. and the Byward Market
- Excellent frontage with huge windows
- 5,440 usable square feet with additional 636 usable square foot balcony and entrance lobby on George St.
- Signed tenants include Rinaldo's Spa, New Look Eyewear and Gourmet Food Store



Canril Corporation  
300-135 Rideau St  
Ottawa, ON K1N 5X4

Tel: 613-234-2296  
Fax: 613-234-4610  
Email: [info@canril.com](mailto:info@canril.com)



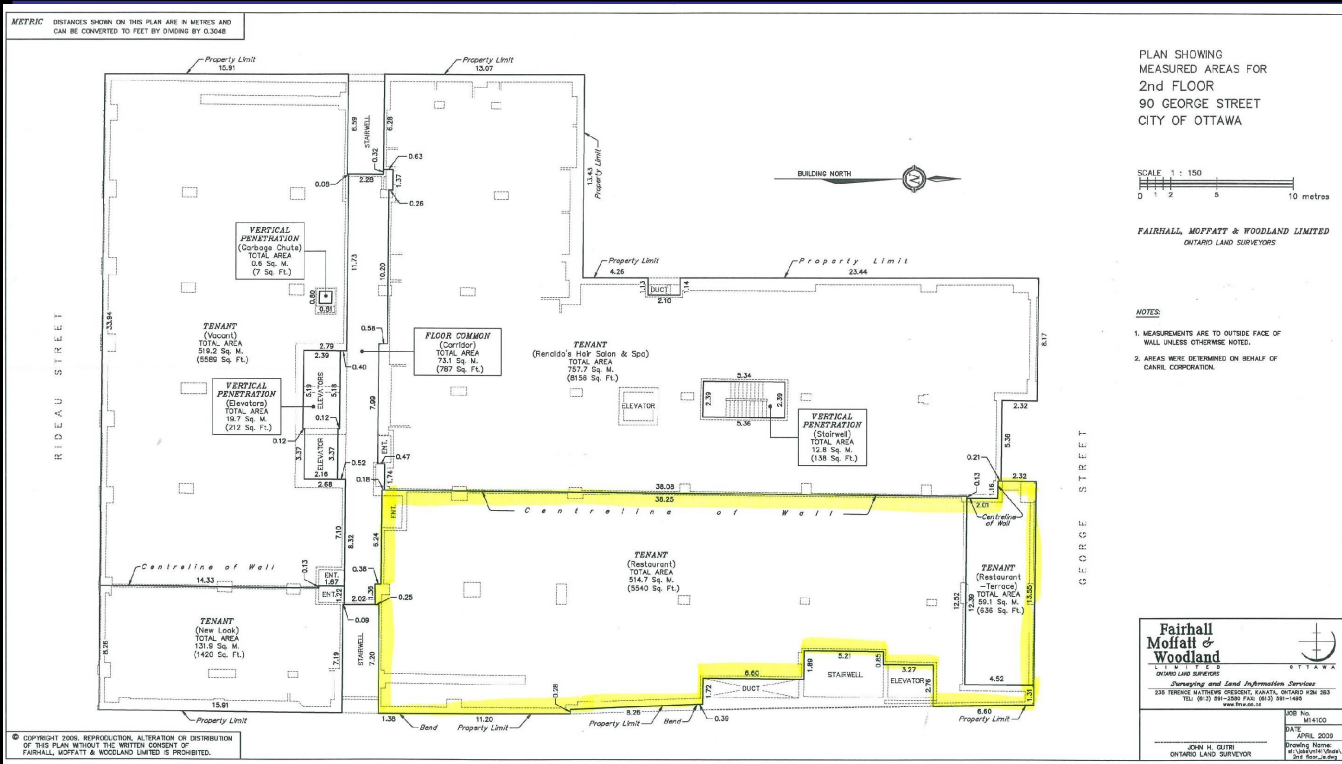

- Available for tenant fit-ups now
- 13'6" bottom of slab to top of slab (average)
- Access from both Rideau and George with a lobby at the ground floor level on George
- Underground valet parking from George St.
- Area demographic expanding at an unprecedented rate with development of residential condos
- Brokers Protected



Canril Corporation  
 300-135 Rideau St  
 Ottawa, ON K1N 5X4

Tel: 613-234-2296  
 Fax: 613-234-4610  
 Email: [info@canril.com](mailto:info@canril.com)

